

LakeView Cottage

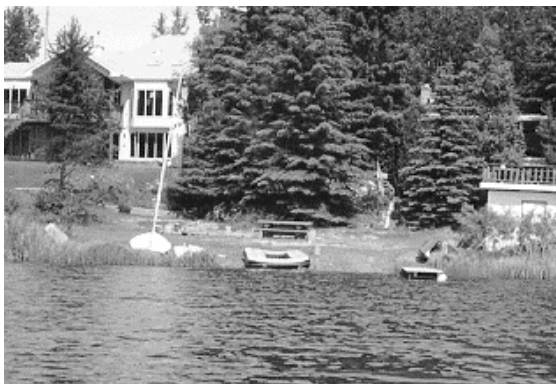

*Year-round resort!
20 minutes west of Edmonton*



DOUG and TONI'S PLACE

Box 2, Site 220, RR 2
Stony Plain, Alberta
T7Z 1X2

SPECTACULAR VIEW:

- Cozy two bedroom 750 sq. ft. lakefront cottage (sleeps 4).
- Quiet setting for yourself, couples, or families.
- Great for bird watching (song birds, ducks, grebes, loons, etc....)

INDOOR AMENITIES:

- Kitchen has microwave, stove, large fridge, toaster, coffee maker, dishes, utensils, pots and pans.
- Lakefront living room with patio.
- Fireplace, cable TV/VCR in family room.
- One and a half baths.
- **Bring own bedding, pillows, towels, dish/tea towels, soaps and toilet paper.**

OUTDOOR AMENITIES:

- Only 20 meters from water's edge!
- Lakefront deck with patio furniture.
- Charcoal barbecue (bring own charcoal).
- **Free use** of rowboat with electric motor, paddleboat, canoes.
- Sandy beach, fire pit and picnic tables.
- Fishing off dock.

COTTAGE ETIQUETTE:

- No smoking indoors
- No outdoor shoes indoors
- No pets.

STONY PLAIN INTERESTS:

Stony Plain Multicultural Centre, Devon Botanical Gardens, Chickakoo Lake Recreation Area, various golf courses.

HUBBLES LAKE:

- One of Alberta's cleanest, quietest lakes with no motor boats.
- Loons nest in this deep (30 meters) lake
- Great blue herons visit the lake.
- Popular for swimming, canoeing, sailing and fishing.

2014 RATES, based on double occupancy:

- **\$775/week, Friday to Friday**

- Check-in time: 6 PM
- Check-out time: 11 AM

Deposit: \$100.

ADDITIONAL CHARGES

- **\$20/night** per person (max. 2).
- **\$15/day** per person for day guests at host's discretion.
- Discounts for longer stays
- No room tax or GST.

FOR MORE INFORMATION:

- Call (780) 963-5587 (all messages returned on a "collect call" basis), or....
- Email: lakeview@lakeviewbnb.biz

Visit our web site for more pictures and Lakeview Cottage brochures:

- www.lakeviewbnb.biz

AREA ATTRACTIONS:

- West Edmonton Mall

- Fort Edmonton
- Chickakoo Lake Recreation Area
- TransAlta Tri Leisure Centre

♥ Doug and Toni's Place ♥

Lakeview Cottage is on the lake lot right beside Doug and Toni's home lot. Toni, speaks French, likes gardening and bird watching. Doug, likes swimming, jazz and computers. They attend Immanuel Lutheran Church of Rosenthal, a nearby country church.

DIRECTIONS (see map):

- **Note:** We are located between Hwy. 16 (Yellowhead) and Hwy. 16A (through Spruce Grove/Stony Plain).
- From Edmonton, go West on Hwy. 16.
- Turn South (or North, if using Hwy. 16A) at **Allan Beach Rd (Range Rd. 13)**.
- **Note:** Allan Beach Road is 4.8 km West of the Stony Plain overpass (S.H. 779).
- Go .3km South on Allan Beach Road (or 2.4 km North if using Hwy. 16A).
- Turn West at **Clearwater Estates Subdivision**. Go approx. 0.7 km to **Lot 43** on lakefront (a gray hillside home with gray cedar decks).
- If you need help, call us at:
(780) 963-5587

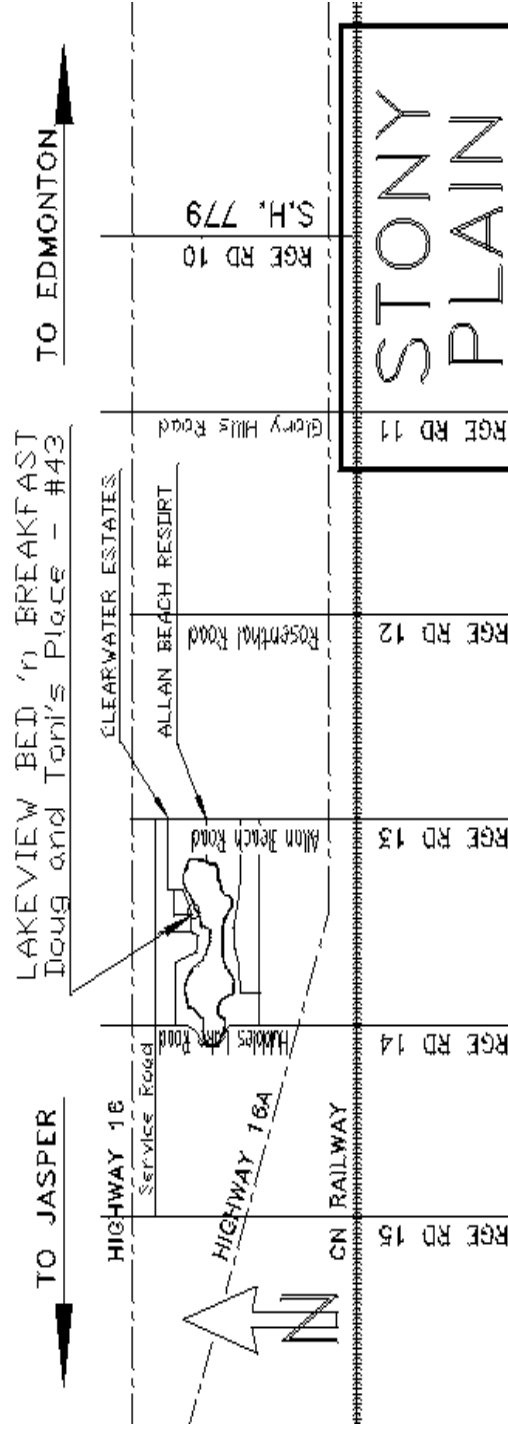

LAKEVIEW COTTAGE - REGISTRATION FORM

Box 2, Site 220, RR 2, Stony Plain, AB, T7Z 1X2

Reservations confirmed on receipt of \$100.00 deposit.

Make certified cheque payable to **Doug Hafso**.

No refund on deposit if cancellation notice is less than 12 calendar days before arrival date.

To register, call **(780) 963-5587** or visit our web site at: www.lakeviewbnb.biz

Or, e-mail us at: lakeview@lakeviewbnb.biz

Name: _____ Phone: _____

Address: _____

Community: _____ Postal Code: _____

Date(s) of stay: _____

Number of guests: _____

Amount of deposit: _____ (Full payment on arrival, cash or certified cheque).

LakeView Cottage 2014 Summer Rates

June to September, Friday to Friday, based on double occupancy

Total cost per week	Total # of weeks	Average \$/night
\$ 775	1 week (7 nights)	\$ 111
\$ 750	2 weeks	\$ 107
\$ 725	3 weeks	\$ 104
\$ 700	4 weeks	\$ 100

Bring your own bedding, pillows, towels, dish/tea towels, soaps and toilet paper. Confirmation of stay upon receipt of a \$100.00 deposit (payable to Doug Hafso).

Mail deposit to:

Doug Hafso
Box 2, Site 220, RR2
Stony Plain, AB, CA,
T7Z 1X2

Ph (780) 963-5587

Additional guests rates:

\$ 20/night/extra person (max. 2)

\$ 15/day/person for day guests at host's discretion.

LakeView Cottage 2014 Off-Season Rates

November to May, Friday to Friday, based on double occupancy

Total cost per week	Total # of weeks	Average \$/night
\$ 575	1 week (7 nights)	\$ 82
\$ 550	2 weeks	\$ 78
\$ 525	3 weeks	\$ 75
\$ 500	4 weeks	\$ 71

Bring your own bedding, pillows, towels, dish/tea towels, soaps and toilet paper. Confirmation of stay upon receipt of a \$100.00 deposit (payable to Doug Hafso).

Mail deposit to:

Doug Hafso
Box 2, Site 220, RR2
Stony Plain, AB, CA,
T7Z 1X2

Ph (780) 963-5587

Additional guests rates:

\$ 20/night/extra person (max. 2)

\$ 15/day/person for day guests at host's discretion.